

Soils Map

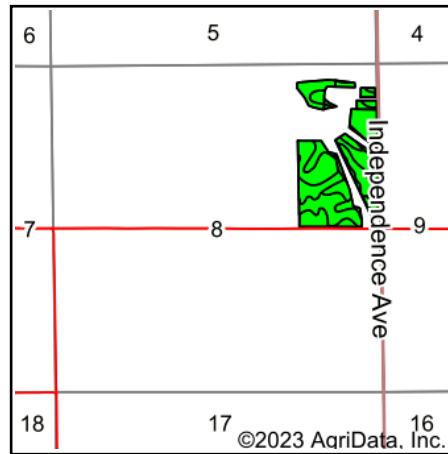

State: **Iowa**
 County: **Muscatine**
 Location: **8-76N-3W**
 Township: **Seventy-Six**
 Acres: **46.43**
 Date: **11/2/2023**

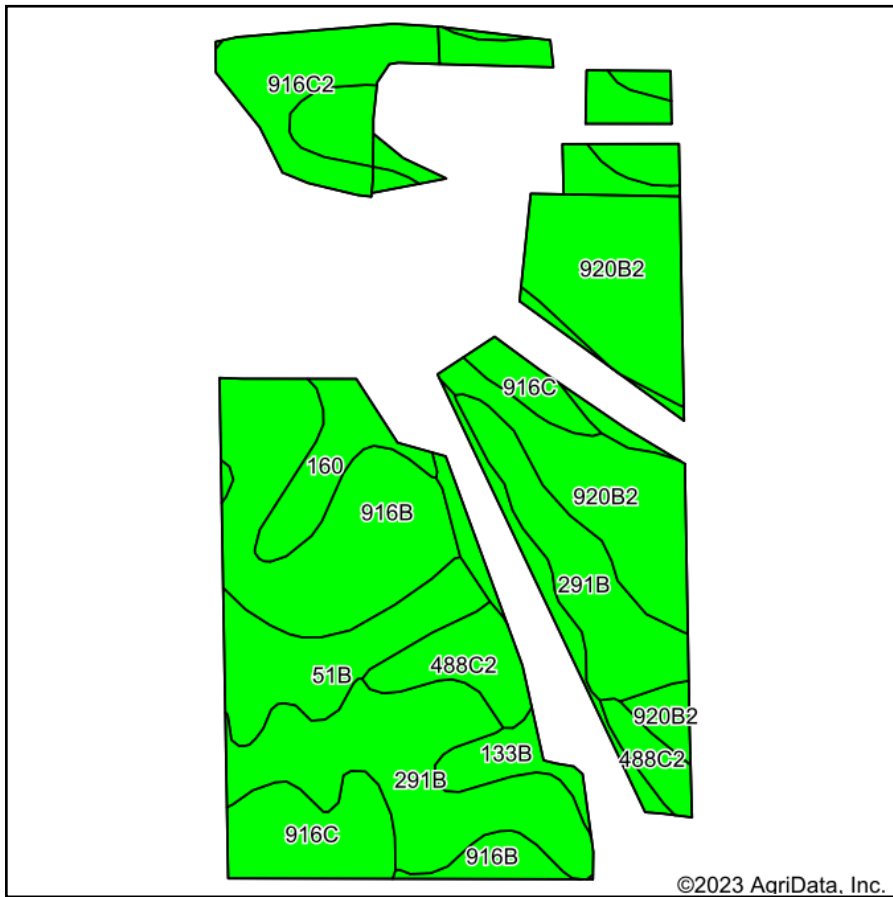

Maps Provided By:

 CUSTOMIZED ONLINE MAPPING
 © AgriData, Inc. 2023 www.AgriDataInc.com



Soils data provided by USDA and NRCS.

©2023 AgriData, Inc.

Area Symbol: IA139, Soil Area Version: 29

Code	Soil Description	Acres	Percent of field	CSR2 Legend	Non-Irr Class *c	CSR2**	CSR	
920B2	Tama silt loam, sandy substratum, 2 to 5 percent slopes, eroded	10.46	22.5%		Ile	89	77	
291B	Atterberry silt loam, 2 to 5 percent slopes	9.50	20.5%		Ile	85	90	
916B	Downs silt loam, sandy substratum, 2 to 5 percent slopes	7.42	16.0%		Ile	88	77	
916C2	Downs silt loam, sandy substratum, 5 to 9 percent slopes, eroded	4.74	10.2%		IIle	80	62	
916C	Downs silt loam, sandy substratum, 5 to 9 percent slopes	3.42	7.4%		IIle	82	65	
51B	Vesser silt loam, 2 to 5 percent slopes	3.36	7.2%		IIw	75	65	
133B	Colo-Ely complex, 0 to 5 percent slopes	3.25	7.0%		IIw	86	75	
488C2	Newvienna silt loam, 5 to 9 percent slopes, moderately eroded	2.48	5.3%		IIle	77	71	
160	Walford silt loam, 0 to 2 percent slopes	1.80	3.9%		IIw	82	65	
Weighted Average						2.23	84.5	75.5

**IA has updated the CSR values for each county to CSR2.
 *c: Using Capabilities Class Dominant Condition Aggregation Method
 Soils data provided by USDA and NRCS.